



THE -NEW ERA- IN POWER DISTRIBUTION



CONTENTS

Two Powerful Solutions	2
How the ECO Pillar System Works	3
About ECO Pillar	4
Customising your ECO Pillar	5
ECO Pillar Accessories	6
EP0	7
EP1	8
EP2	9
EP2S	10
EP3	11
EP3.5	12
EP4	13
EP6	14
EP6TALL	15
TAPPAT Link Pillar - 2 way	16
TAPPAT Link Pillar - 3 way	17
Subterranean Utility Vault	18
TAPPAT Link Box - Fully Insulated 2 & 4 way	19
B&H Link Box - 2 & 4 way	20
Aluminium Pillars	21
Fibreglass Cabinets	22
TUDES - Total Underground Distribution System	23
How The TUDES System Works	24
Residential Installation	25
Residential & Commercial Use	26
Cambridge Town Centre - Case Study	27
TUDES Parts & Accessories	28
PIT300D Kitsets - No Resin Kit	29
TUDES Kitsets - Include Resin Kit	30
TUDES Kit Additional Options & Accessories	31
Earth Rod Protection Boxes	32

TWO POWERFUL SOLUTIONS



Specifying ECO Pillar or TUDS, for residential or commercial applications, is about more than just upgrading to a better-looking unit. The thinking behind the two systems, indeed the very reason they were created, was to eliminate existing distribution pillar weak points and develop a future-proof system that still manages to be cost-effective.

Essentially, a local power supplier can, and sometimes will, choose an existing option when distributing power from the mains to a dwelling. In the past this has often been one of the older, not so attractive, style of distribution pillar, ECO Pillar and TUDS both give you, new more aesthetic solutions.

As an individual or private developer you're perfectly entitled to make your own choices — as far as keeping ugly features off the landscape is concerned. So ECO Pillar and TUDS supply a ready-to-use solution using componentry that specifiers and tradesmen are familiar with. The robust construction, compact profile and secure, locking system used in every ECO Pillar reduce the risk of accidental or intentional damage. And, due to the modular design, manufacturing and installation costs stay competitive. The TUDS system removes the whole issue visually, apart from a secure service hatch that sits flush with the ground.

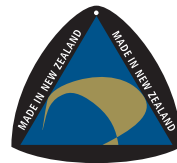

Not many companies choose to keep their best features completely out of sight, but then these are unusual products from an innovative company.

Why are they unusual products? For a start, they were created in direct response to a problem that had never been solved to anyone's satisfaction — the problem of power disruption through damaged distribution pillars. It turned out that the majority of those pillars were destroyed simply by being run over by cars in everyday use. So TransNet came up with a Total Underground Distribution System (TUDS), which incorporates a multitude of electrical fittings in a below-ground capsule with a vandal resistant cap that sits flush with the ground.

The next logical step was to develop vastly improved distribution and link pillars for applications where TUDS can't be used. The ECO Pillar is unobtrusive, tough, environmentally friendly, and makes cable installation easier than the unit it replaced (another bonus is that it's often cheaper than its predecessor).

The advantages over the traditional (also unsafe, ugly, expensive and crude) distribution boxes are apparent at a glance. The obvious electrical reticulation solution for anyone about to start on a building project is TUDS or ECO Pillar.



HOW THE ECOPILLAR SYSTEM WORKS



FEATURES & BENEFITS

- Fully modular system to meet all network requirements
- Accommodates multiple switchgear combinations
- Compact, environmentally pleasing
- Recyclable
- Excellent UV stability Rotathene 6329 plastic
- Mechanically robust
- Vandal resistant
- Easy to install
- Unique serial number

ABOUT ECOPILLAR

Built from repurposed Rotathene 6329 UV stable plastic, the ECO Pillar will take the knocks and come back for more. It's designed specifically for customers who demand safety, performance and unobtrusive good looks from their electrical reticulation systems. A unique range of fastening systems ensures protection from the less civic-minded elements of the public whilst giving the technician easy access. Internally, all components are industry standard and fit perfectly in ECO Pillars.

Externally, ECO Pillar visibly has a compact installation footprint. The corrosion free, environmentally friendly outer housing has a contoured design with no sharp edges, and can be ordered in a range of colours on request. This isn't just a plastic box with some electrical fittings inside — this is an integrated system, designed by people in the industry for people in the industry.

FAQS

1 Why change to the ECO Pillar system?

- Safety to members of the public and workforce.
- Inventory rationalisation due to modular design.
- Cost effective, price and labour savings.

2 Is plastic in the ECO Pillar UV stabilised?

- Yes, material is repurposed Rotathene 6329 Ultra UV.
- Compliant with AS/NZS 4766 tank standard.
- Fuse panels are made of flame retardant PVC.

3 What is the difference between the ECO Pillar Models?

- Type 1 ECO Pillar (EP1) components are watertight, other ECO Pillars use standard fittings.
- EP4 was designed for switchgear.
- EP6 was designed for safety – NO exposed electrical components

4 How much do they cost?

- Cost effective installation time.
- Competitively priced in the market.

FEATURES THAT TACKLE THE MAJOR ISSUES

- Multiple fastening options.
- Compact installation footprint.
- Environmentally acceptable.
- Strong vandal resistant construction.
- Incorporating the latest next generation electrical fittings.
- Manufactured from corrosion free, UV stable, quality plastic, repurposed Rotathene 6329.
- Contoured design means no sharp edges.
- A compact range which incorporates a multitude of electrical fittings.

FROM THIS



TO THIS



WHAT SETS US APART

- Designed by people in the electrical industry to overcome the shortcomings of existing products in the market.
- This is a system, not just a plastic box with electrical fittings inside.

NZ Patent Number 548175 pending,
NZ Design Registration applied for.

CUSTOMISING YOUR ECOPILLAR



Security Torx Screw



Security Screw & Padlock



Security Screw, & Key Lock



FULL CUSTOMISATION AVAILABLE

- Lid details specific to your design requirements.
- Component kits based on usage requirements.
- Pillar colours & sizes all designed to requirements.
- Neutral bar & it's placement adjusted to individual network requirements.



ECOPILLAR ACCESSORIES

The ECO Pillar range wouldn't be complete without a range of accessories and hardware created specifically for use with this revolutionary range of distribution pillars.

PANEL KITS

Made from Fire Retardant plastic, ECO Pillar panels have been injection moulded with holes to accommodate standard electrical fittings. Panel kits come complete with stainless steel self tapping screws for fastening to pillar body.

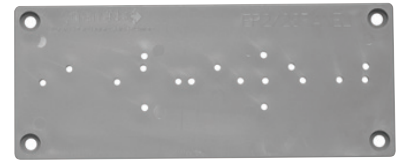

TransNet Code	Description
EPOPANELKIT	EPO GREY PVC PANEL DRILLED WITH SCREWS, 2 FUSE
EP2/2SPANELKIT	EP2/2S GREY PVC PANEL DRILLED WITH SCREWS, 5 FUSE
EP3PANELKIT	EP3 GREY PVC PANEL DRILLED WITH SCREWS, 6 FUSE

FUSE KITS

We have a range of fuse kits available for each of our ECO Pillar models and these fuse kits can be supplied separately or installed onto the panel prior to shipping.



TransNet Code	Description
EPFUSE32AKIT	32A FUSE AND ASSEMBLY TO PANEL
EPFUSE63AKIT	63A FUSE AND ASSEMBLY TO PANEL
EPFUSE100AKIT	100A FUSE AND ASSEMBLY TO PANEL

SELF TAPPING SCREWS

Self tapping stainless steel screw designed specifically for use with ECO Pillar gear panels. These screws will hold the panel or fuse carrier in place directly without the need for a nut and washer in behind.



TransNet Code	Description
SS316STBCTRUWP1012	10G X 12MM FUSE MOUNTING SCREW S/S 316 POZIDRIVE
SS316STBCTRUWP1016	10G X 16MM PANEL MOUNTING SCREW S/S 316 POZIDRIVE

TOOLS

Security and public safety are key to the ECO Pillar range, with a Stainless Steel key lock available on most models and Torx 40 screws standard on the entire range.



TransNet Code	Description
EPTORXSREWDRIVER	ECOPILLAR LID SECURITY SCREW TOOL
EPTSSLOCKKEY	STAINLESS STEEL LOCK, KEY - TRIANGULAR
EP4WAYKEY	4 DIFFERENT PILLAR KEYS IN ONE TOOL



ECOPILLAR TYPE 0 - EPO



The EPO incorporates a slimline low visibility profile and two captured Torx40 screws for fastening. It can accommodate one or two 32, 63 or 100amp fuses. Ideal for use in low demand installations like small homes, utility buildings, street light circuits and illuminated bus shelters.

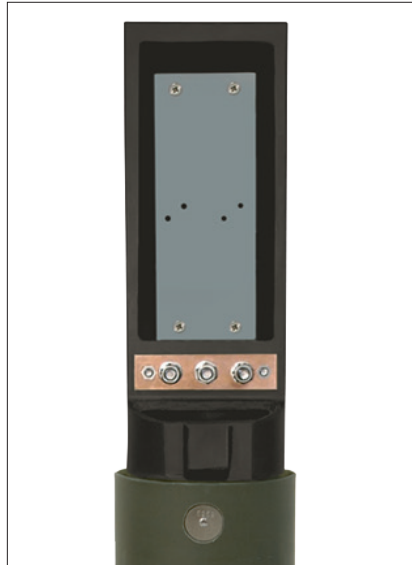

TYPE 0 CAPABILITIES:

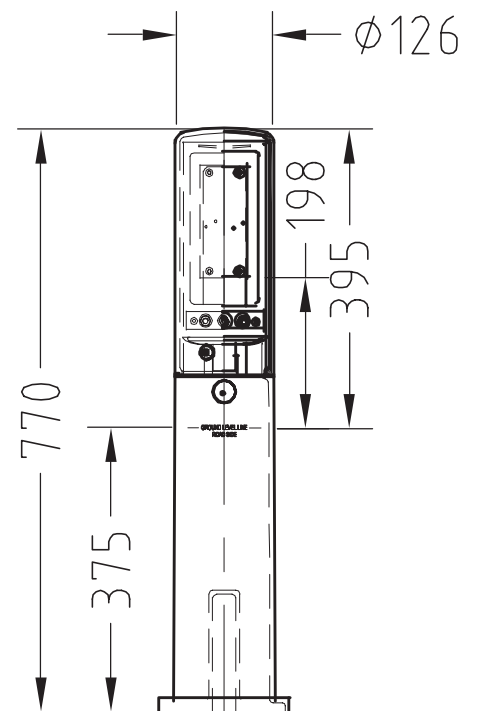

ECOPILLAR TYPE 1 - EP1

A completely watertight unit with safe-to-touch electrical fittings. Uses the industry approved TransNet fastener free locking lid system, eliminating fasteners and requiring one simple tool for access.

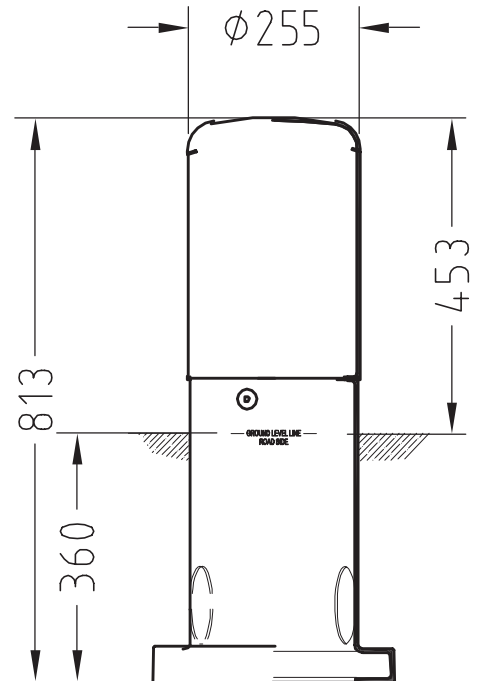

TYPE 1 CAPABILITIES:



7-1201146-7 Gelport watertight neutral bar for Al/Cu cable 4-150mm² (larger 16-240mm² available) ANSI C119.1,2002.



Guro MM5 Underground Resin Breach Joint Kits, suit Al/Cu cables of 3 or 4 core 50-240mm² with tails of 6-120mm².



Removable mounting rack accommodates 3xK221, 4x65U and 1x4 way Gelport.



Fastener free locking system ensures maximum safety for workers & public alike.



65U watertight 30amp fuse holder accepts Al/Cu conductor 2.5-16mm².

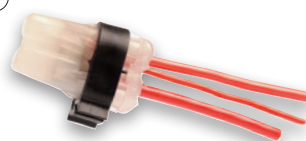

2-1200171-6 Gelcap Pilot Wire Connection Block accepts Al/Cu conductors from 2.5-70mm².



K221 watertight 100amp IPC fuse holder accepts Al/Cu conductors of 6-50mm².

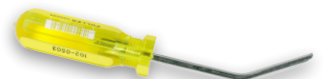

ECOPILLARLIDTOOL Tool for opening EP1 style ECOPIllar with fastener free locking system.

ECOPILLAR TYPE 2 - EP2



The compact and unobtrusive design keeps visual impact to a minimum. Uses the TransNet captured torx bolt locking system and carries industry standard electrical fittings (BS 88, IEC269).



TYPE 2 CAPABILITIES:



Up to 10 each
32/63/100amp fuses



OR 1x160amp DIN00
disconnecter with 2 each
32/63/100amp fuses

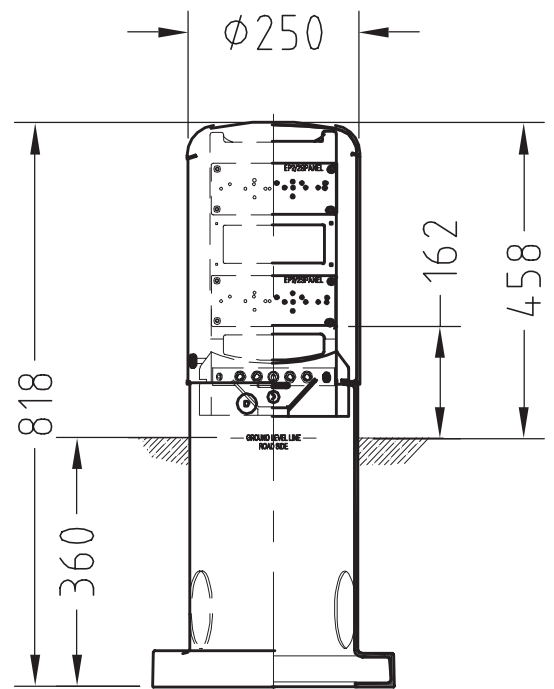

EP2

ECOPILLAR TYPE 2 SHORT - EP2S

The shorter stature of the EP2S further enhances the compact and unobtrusive design keeping the visual impact to a minimum. Using the TransNet captured torx bolt locking system and carrying industry standard electrical fittings (BS 88, IEC269), this unit comes with just a single mounting panel for up to 5 fuses.



TYPE 2 SHORT CAPABILITIES:

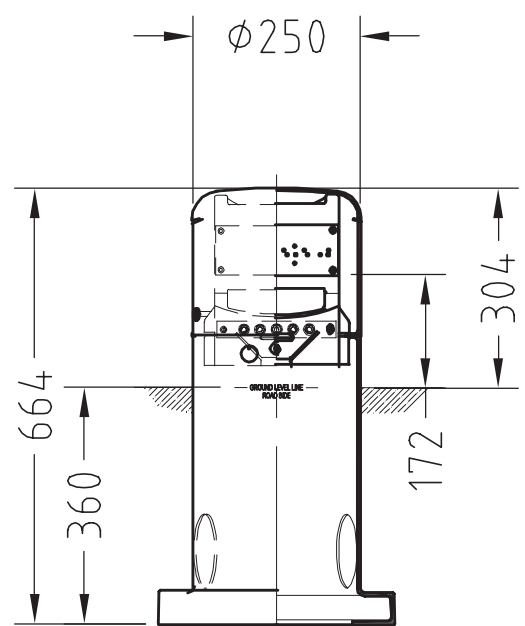

EP2S

ECOPILLAR TYPE 3 - EP3



Incorporates the aesthetically pleasing profile of the ECO Pillar range with captured torx bolt locking system and use of industry standard electrical fittings. This unit has a slightly larger footprint while maintaining low visual impact on the environment.



TYPE 3 CAPABILITIES:

Up to 14 each
32/63/100amp fuses.

1 each 160amp DIN00
disconnecter with 3 each
32/63/100amp fuses.

2 each 160amp DIN00
disconnectors.

1 each 250amp DIN1
disconnecter with 4 each
32/63/100 fuses.

*Additional combinations possible

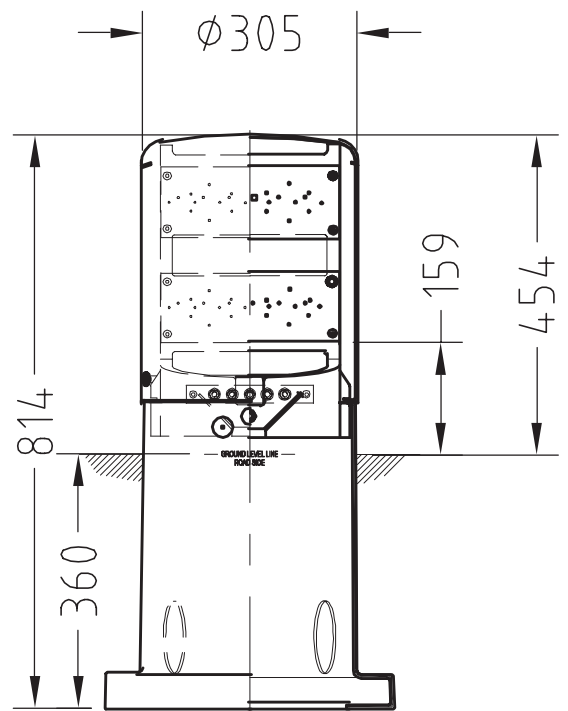

ECOPILLAR TYPE 3.5 - EP3.5



The big brother to the EP3, the EP3.5 was designed to give a bit more room inside for larger cables, crossing of cables and generally a bit more room to work. With the same capacity as the EP3, this unit is versatile and can accommodate many different combinations of fuses and disconnect switches up to 3 way 250amp. The footprint of the EP3.5 is slightly larger to allow for the extra room.



TYPE 3.5 CAPABILITIES:

Up to 14 each 32/63/100 amp fuses

1x160 amp DIN00 disconnecter & 3 x 32/63/100 amp fuses

2 x 160 amp DIN00 disconnectors

1 each 250 amp DIN1 disconnecter with 4 x 32/63/100 fuses

* Additional combinations possible

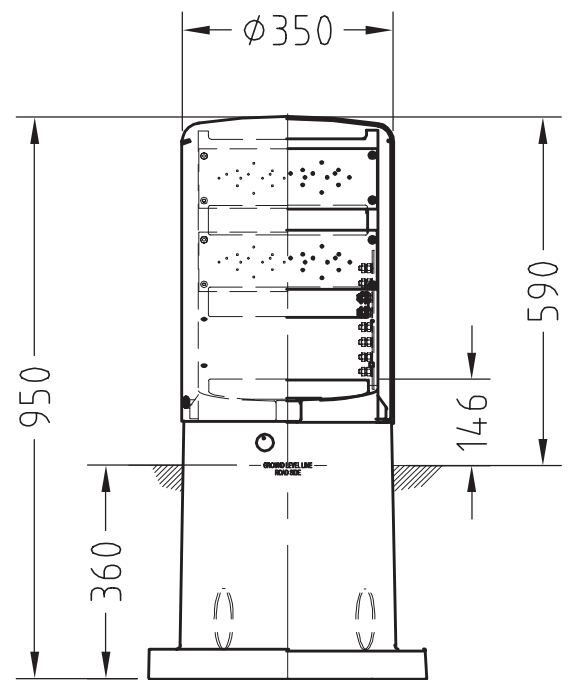

EP3.5

ECOPILLAR TYPE 4 - EP4

The EP4 is the largest in the ECOpillar range and is designed to house the larger 400amp and 630amp Horizontal Disconnect Switches along with many combinations of smaller disconnects and fuses. This pillar comes complete with captured Torx40 screws.

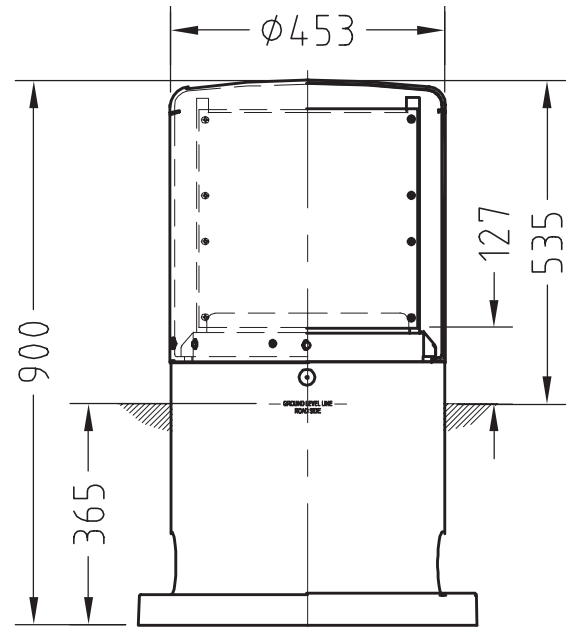

EP4

TYPE 4 CAPABILITIES:



Up to 24 each of 32amp fuses, OR
20 each of 63/100amp fuses.



3 each 160amp
DIN00 disconnect.



Mix of Disconnect switches with
additional service fuses if required



Multiple DIN disconnects with
63amp fuse links if required



2 each 250amp
DIN1 disconnect.



Will accommodate any number of
monitoring or switching devices

*Additional combinations possible

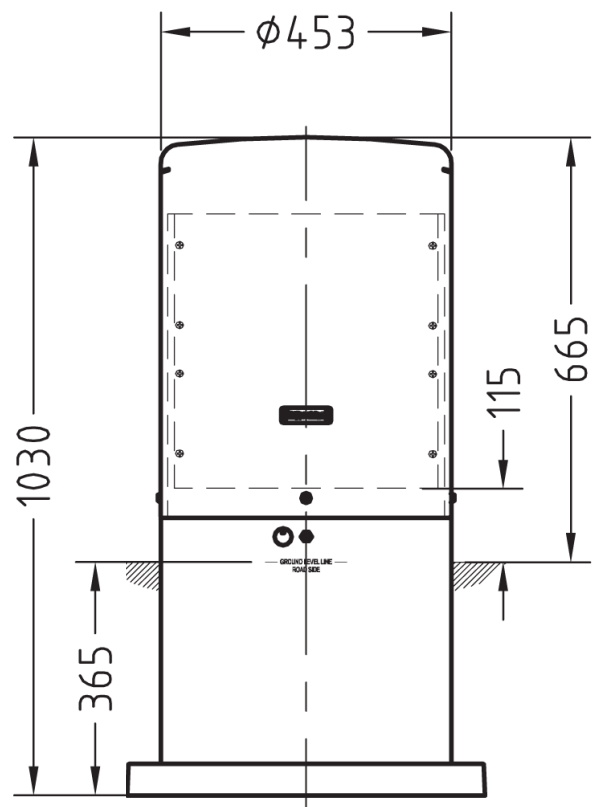

EP4TALL

ECOPILLAR TYPE 6 - EP6



The most versatile of the ECOPIllar range, the EP6 was designed to accommodate the requirements of a network link and junction pillar as well as being capable of housing service fuses, disconnect switches and any number of combinations of hardware. The feature setting this pillar apart is the ability to house submersible GelPort connectors in the base which enable the looping of cables up to 300mm² in and out of the pillar.

Designed to maximise the safety of field staff, this pillar has no exposed live parts, more room to work inside the pillar and the added benefit of a removable rack so all cables can be made off without the inconvenience of the rack hindering the workspace.

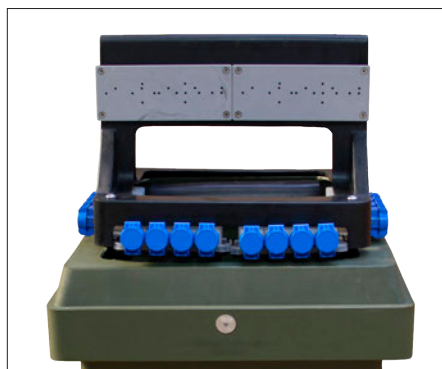

TYPE 6 CAPABILITIES:

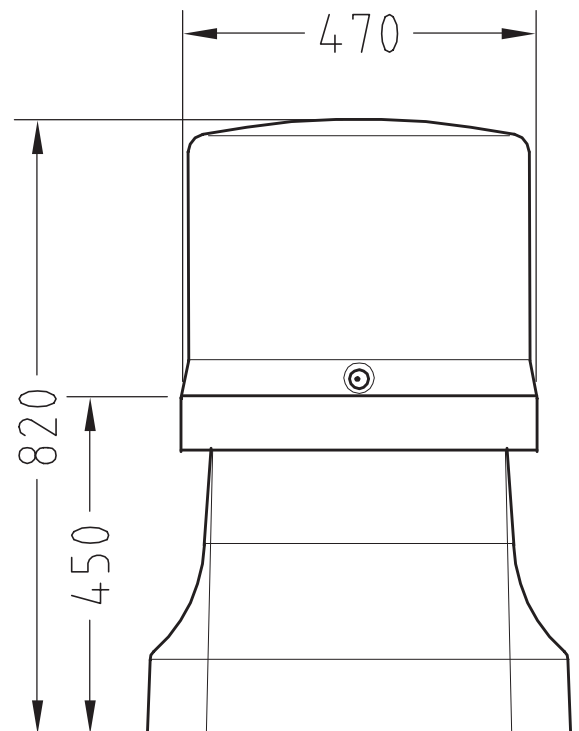

EP6

ECOPILLAR TYPE 6 TALL - EP6



The EP6TALL has the same footprint as the EP6 but it has an additional internal rack. The EP6TALL means double the number of fuses as the EP6, but not only that, the larger internal area offers flexibility for what can be accommodated inside. This unit is perfect for accommodating network link and junction pillar hardware as well as being capable of housing service fuses, disconnect switches and any number of combinations of them all. The feature setting this pillar apart is the ability to house submersible GelPort connectors in the base.

Designed to maximise the safety of field staff, this pillar has no exposed live parts, more room to work inside the pillar and the added benefit of a removable rack so all cables can be made off without the inconvenience of the rack hindering the workspace.



TYPE 6 TALL CAPABILITIES:

 <p>Multiple 63/100amp fuses</p>	 <p>Will accommodate any number of monitoring or switching devices</p>
 <p>Mix of Disconnecter switch sizes with additional service fuses if required</p>	 <p>Multiple DIN disconnecter with 63amp fuse links if required</p>

*Additional combinations possible

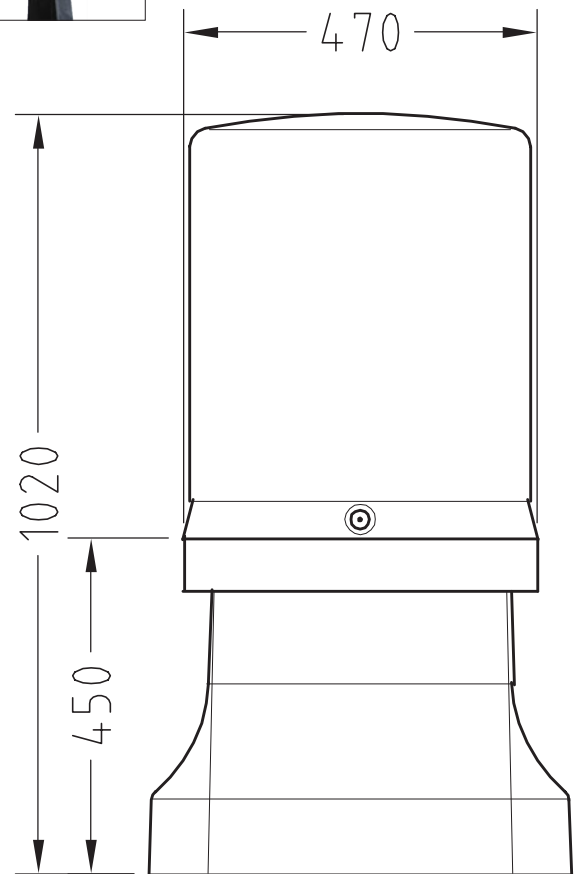

EP6TALL

TAPPAT LINK PILLAR - 2 WAY 600AMP

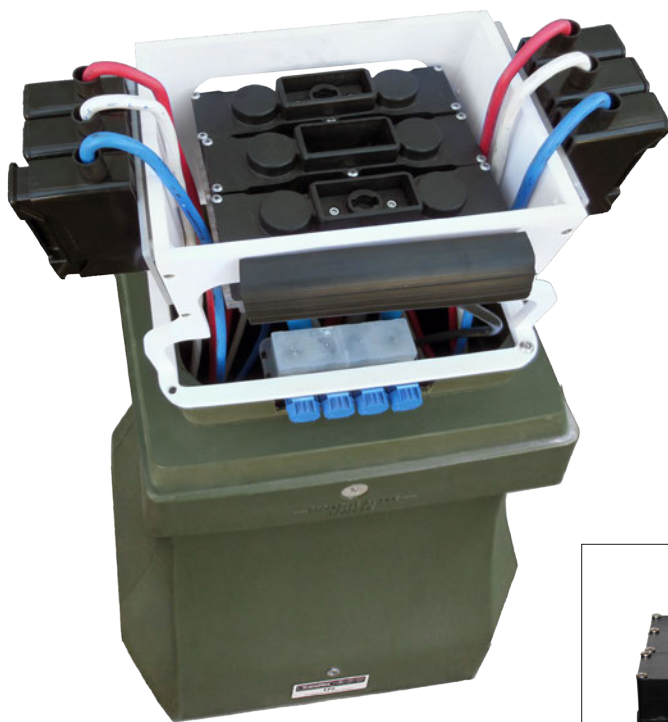

Allows greater flexibility when isolating, paralleling, back feeding or sectionalising LV cables. Perfect for placement at intermittent locations along a LV cable run as an open point between transformers or every second boundary giving the network the ability to restore supply to customers along a faulty cable run except the customer with which the fault is located. This concept would also apply to planned outages.

Minimal disruption during routine maintenance and replacement projects will become the norm as each pillar is back fed via the Tappat linking system, to the boundary either side of the job.

Increased safety through reduced live jointing requirements.

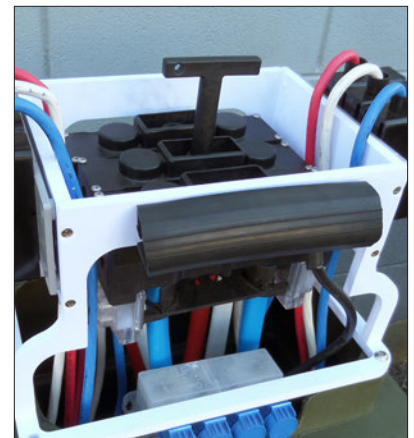

Part Numbers:

TE-LINK-2-3-G

2 way, no pillar

TE-LINK-2-3-G-EP6

2way c/w EP6 pillar

FEATURES & BENEFITS:

- Tinned Brass connections eliminate the possibility of corrosion
- 185mm² to 300mm² mains, up to 50mm² service connections
- Tested to 600 AMPS
- GelPort – main neutral (16mm²– 185mm² x 1port & 185– 300mm² x 2ports)
- Up to 6 service fuses can also be accommodated (2 x 3 phase or 6 x 1 phase, 32/63/100amp or street light fusing)
- UV Stable repurposed Rotathene 6329 plastic pillar (TE-LINK-2-3-G-EP6)
- Range of locking systems available
- Low profile/unobtrusive design
- Functional switching capacity reduces customer outage minutes during fault conditions

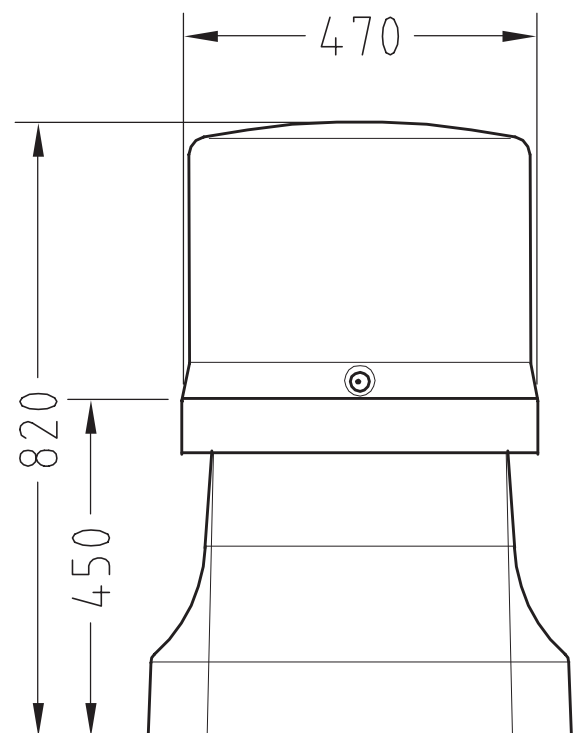

EP6

TAPPAT LINK PILLAR - 3 WAY 600AMP

This pillar gives the network the ability to parallel or isolate LV mains cables and can also serve as a demarcation point for industrial customers. It would be well placed along a low voltage cable run where a tee off is required to supply a side street.



Part Number: TE-LINK-3-3-G-EP6

FEATURES & BENEFITS:

- Tinned Brass connections eliminate the possibility of corrosion
- Touch safe components
- 185mm² to 300mm² mains
- Up to 50mm² service connections
- Tested to 600 AMPS
- UV Stable repurposed Rotathene 6329 plastic pillar (TE-LINK-3-3-G-EP6)
- Range of locking systems available
- All products come with an installation instruction & component list
- Functional link and isolation capacity allowing minimal customer outage minutes during fault conditions
- To aid quick and easy fault finding in LV networks
- Maximum flexibility control of your LV network

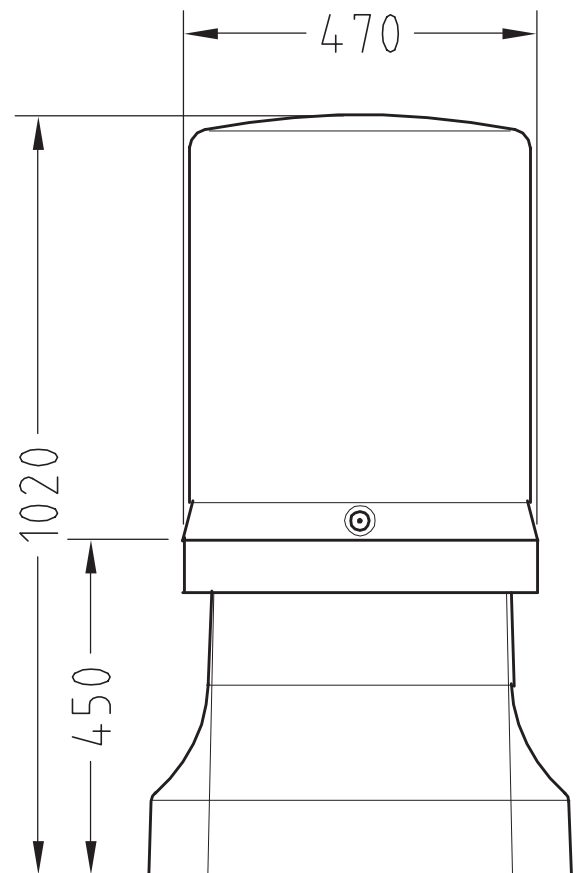

EP6TALL

SUBTERRANEAN UTILITY VAULT 160AMP



This 160 amp unit offers a solution for commercial sites and places where 100 amp solutions are not sufficient. The 160 amp disconnect gives customers the same functionality as an above-ground solution without the clutter.

The subterranean nature of this solution is perfect for pedestrian accessways and areas with a high volume of foot traffic. They also offer an aesthetically pleasing solution to reduce visual impact on the surrounding landscape. Housed in an IP68 hinged electrical enclosure, the 160 amp disconnect works exactly as it would above ground. The waterproof enclosure has glanded cable entry ports and is housed in a diving bell for added protection from moisture ingress.

The pit itself has a small footprint, is able to be installed in light traffic areas [footpaths and driveways] and can be parked on or driven over. It can be locked with a stainless steel key lock if required.



Dive Bell Lid



IP68 Electrical Enclosure

Part Number: TNSUV160A

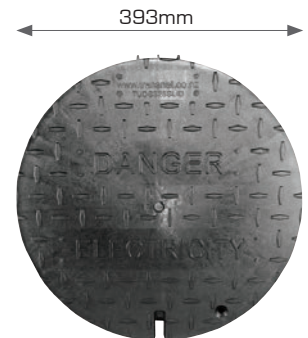

FEATURES & BENEFITS:

- Fully lockable
- Diving Bell lid bolted in place
- Sits flush with the ground
- 160 amp 3Ø fuse disconnect fitted
- Double layer protection from moisture - an IP68 electrical enclosure and an additional Diving Bell enclosure

TESTING & SPECIFICATIONS OF ENCLOSURE:

- Meets requirements of AS3996-2006 -Class B for load to 80kN
- Meets requirements of AS/NZS 3661.1 for slip resistance

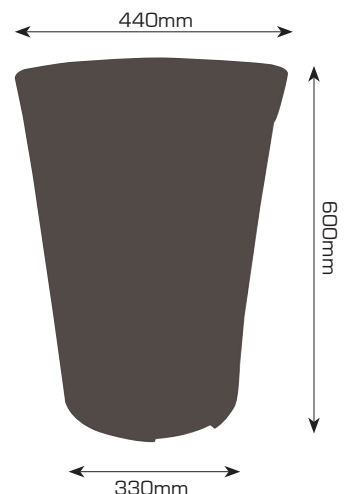

TAPPAT LINK BOX - 2&4 WAY 600AMP



This fully insulated solution allows the network to parallel or isolate low voltage mains cables using the diving-bell principal, meaning it is housed in a totally submersible underground pit. Perfect for situations where council bylaws stipulate underground installations only.

It is a like for like replacement for existing bitumen filled link boxes at the end of their asset life. Available in 2way or 4way configuration with 600amp Cam Lock links included.

Part Numbers:

TAP10510-NZ	2way untailed
TAP10710-NZ	4way untailed
TAP10710-NZ-TAILED	4way tailed (by special request only)



FEATURES & BENEFITS:

- Fully insulated system, there are no exposed live contacts
- Depth of pit can be tailored to the requirements of each installation by adding or removing enclosure modules.
- Jacking screws allow lid to be adjusted to uneven ground levels.
- Functional switching ability allows for easy sectionalising during fault conditions reducing outage times.
- Touch safe fittings and no exposed live metal work
- Complies with all applicable international standards: EN50393:2006, EC60439.5:2006, Ed2.0, C.81/3:1996, Pit & Lid meet B125 & EN124 standards
- Range taking - mains cable up to 300mm²
- Pit is made of durable HDPE plastic
- Two piece concrete lid can hold 45N/mm² & comes with an identification plate cast into it
- Stabilising base pad included with every kit
- Complete with circuit I.D. labels
- Cam Lock links tested to 600 amps
- Overall Pit dimensions
 - 2way: 412mm X 412mm X 564mm High
 - 4way: 712mm X 562mm X 564mm High

Dimensions

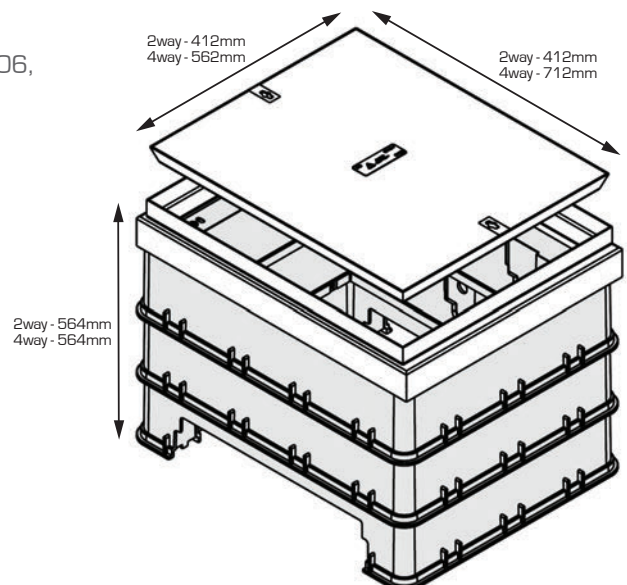

B&H MK3 LV LINK BOX - 4 WAY



Low voltage underground 4 way link boxes are used for connecting and switching adjacent sections of low voltage 3 or 4 core cable from 70mm² to 300mm². They are supplied complete with a plastic foundation pad, outer enclosure set and concrete filled.

FEATURES & BENEFITS:

- Compact modular concept reduces weight and space required for link box positioning, making installation possible in congested areas whilst reducing excavation and reinstatement costs.
- Retained ABS moulded lid replaces the traditional cast iron diving bell lid, reduces weight and is non-conductive making operation safer.
- Integrated locking facility combined with the lid retaining system and toolbox, with fail safe positioning and operation.
- Clear vacuum-formed body shell allows both easy cable installation and inspection prior to resin fill. Shell designed for crossing 300mm² cores with sufficient resin coverage.
- Single resin casting eliminates moisture ingress issues that are associated with multiple cast link boxes.
- Reduced number of connections improves electrical performance and product longevity.
- Error-proof factory assembly due to torque and system control software and zero-fault technology.

STANDARDS:

- Pit frame & cover meet BS EN 60947-1:2004 B125 & EN124 standards
- BS EN 50393:2006
- ER C81/4 1999

Note: 2 Way link box kit available on special request.

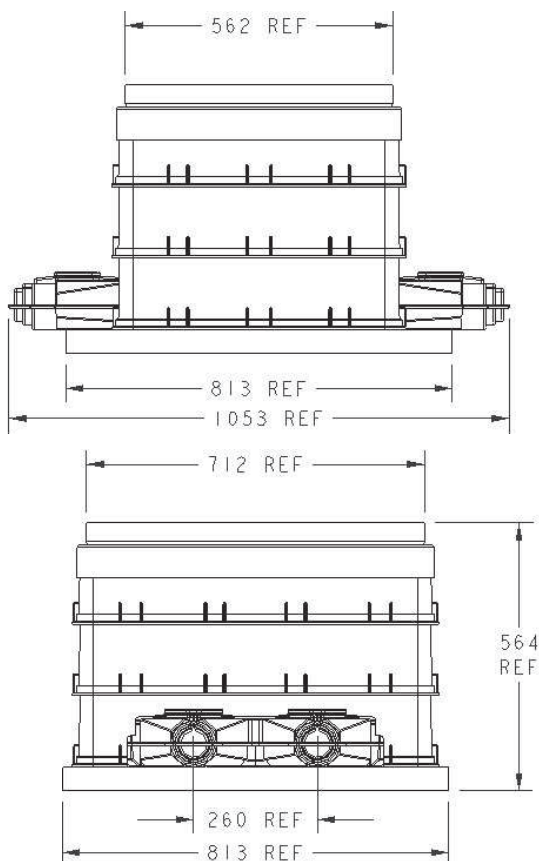

Part Number:

LV-LINKBOX-2W-COMPLT 4 way

ALUMINIUM PILLARS

These robust industry standard cabinets are made from 2.5mm marine grade alloy powdercoated with a rippled industry standard green coating. The standard range includes three sizes - 300mm, 500mm and 700mm wide with others available on request (conditions may apply).

The hinged door makes for easy access to authorised persons while the secure locking mechanisms can be included to ensure public safety and no unauthorised entry.

The removable lower front sill allows for easy access to the cable installation area.

The hot dip galvanised underground base is supplied with all TransNet Aluminium cabinets and if required a viewing window can be added (at additional cost).

FULLY CUSTOMISABLE TO YOUR REQUIREMENTS:

- Perfect for use as Link pillars, Customer service pillars & Metering pillars
- Can be installed freestanding or recessed into walls/fences
- Custom sizes available (on request, some conditions may apply)
- Locking mechanism of your choice can be included
- Additional security options are also available
- Made from quality materials - Hot dipped galvanised base, Aluminium or Stainless steel (special order only) body powder coated in Green to match current NZ industry standard
- Custom branding including warning labels, network asset numbers & identification labels can be installed prior to delivery
- Hinged cabinet doors, earthed to cabinet body for safety - this can be done in accordance with network requirements
- Available standard as empty cabinets, any inclusions must be confirmed at time of order
- Tinned Copper Busbars and Apator Switchgear used to populate cabinets to customer requirements



STANDARD SIZE RANGE:

Dimensions (mm) shown are A x B x C as per illustration below, other pillar sizes available on request.

EPA300	300(b) x 870(c) x 265(a)
EPA500	500(b) x 880(c) x 330(a)
EPA700	700(b) x 880(c) x 330(a)

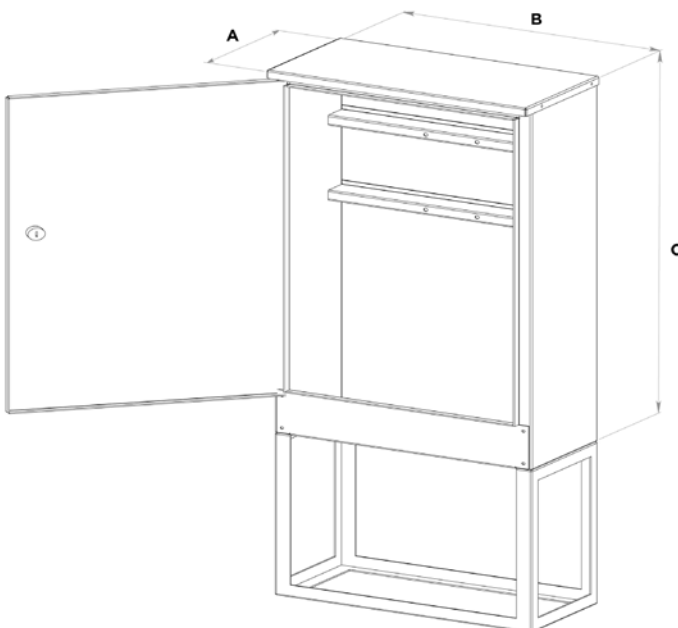

*Combination shown is indicative only, any components are included at additional cost.

ELSTA - FIBREGLASS CABINETS

Made of hot pressed, fibreglass reinforced polyester ELSTA cabinets by Mosdorfer are the ideal solution for all applications especially in the outdoor environment.



Series X - Freestanding Cabinets



Series F - Freestanding Cabinets

FEATURES & BENEFITS:

- UV resistant due to special surface protection, life span of more than 30 years
- Noncorrosive materials
- Door and back panel with profiled anti-poster surface
- Easy to assemble due to modular design
- Hinged doors with an opening angle of 180° and can be dismantled without tools
- Three point locking system with swivel lock, prepared for standard profile semi cylinder locks
- M10 Stainless steel threaded inserts moulded into the back panel for direct assembly of busbars, mounting plates, frames etc
- Double insulation, protection class II
- IP44, optional IP54
- Ambient temperatures -50°C up to +125°C

STANDARDS:

- IEC EN60439-1:2000-10
- VDE 0660 Teil 505:1998-10
- IEC EN60439-5:1996
- ISO 9001-2000
- IEC EN60439-5/A1:1998-11

DIMENSIONS:

Series X Width (mm) 460, 590, 785, 1115
 Height (mm) 850, 1250
 Depth (mm) 320

Series F Width (mm) 440, 590, 785, 1115,
 Height (mm) 650, 850, 1080,
 Depth (mm) 200, 250, 320, 470, 635



TUDS - TOTAL UNDERGROUND DISTRIBUTION SYSTEM

LESS, FINALLY, IS MORE

IN THE WORLD OF UTILITY DISTRIBUTION.



The versatility of TUDS means that, in domestic applications, you can install a compact pit in a driveway, a lawn, footpath or terrace. Unsightly (and space-stealing) distribution pillars are no longer needed. Each TUDS pit can comfortably supply up to 9 single phase dwellings.

In business districts, service pillars can be replaced with TUDS pits quickly and efficiently; the flexibility of the system means that services can still be placed in high foot traffic areas, but no longer encroach on the functionality of the area. Cluttered storefronts can be a thing of the past, with obvious benefits in terms

of street appeal. Another obvious issue is public safety; in the days when there was no alternative there might have been some excuse for placing hazards in the path of the elderly and unwary, but with the TUDS system now available, and at such reasonable cost, there's no need to inconvenience pedestrians.



SAFE, SECURE & UNOBTRUSIVE

Being safe and secure for the public, yet easily accessible to workers is a challenge easily overcome when using TUDS. TUDS lids

latch into place and require a tool to access them. If the latch alone is not adequate for your requirements, we have a stainless steel spring lock available,

which when fitted, is operated by a special triangle access key. The spring action ensures the lid is never left "unlocked".



*Stainless Steel Key Lock is an optional extra accessory which must be specified at time of order.

HOW THE TUDS SYSTEM WORKS

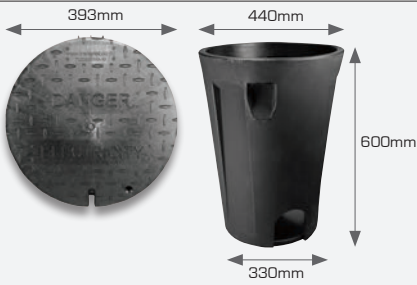

Pit base and lid: manufactured from durable, black UV resistant plastic compounds. The lid latches into place & requires a tool for access



Pit Fuse K199: Used to connect the customer's service to the underground supply cable. Fully submersible design rated to IP68. Accepts barrel fuse links up to 100amps & copper or aluminium cable, 6mm²- 50mm².

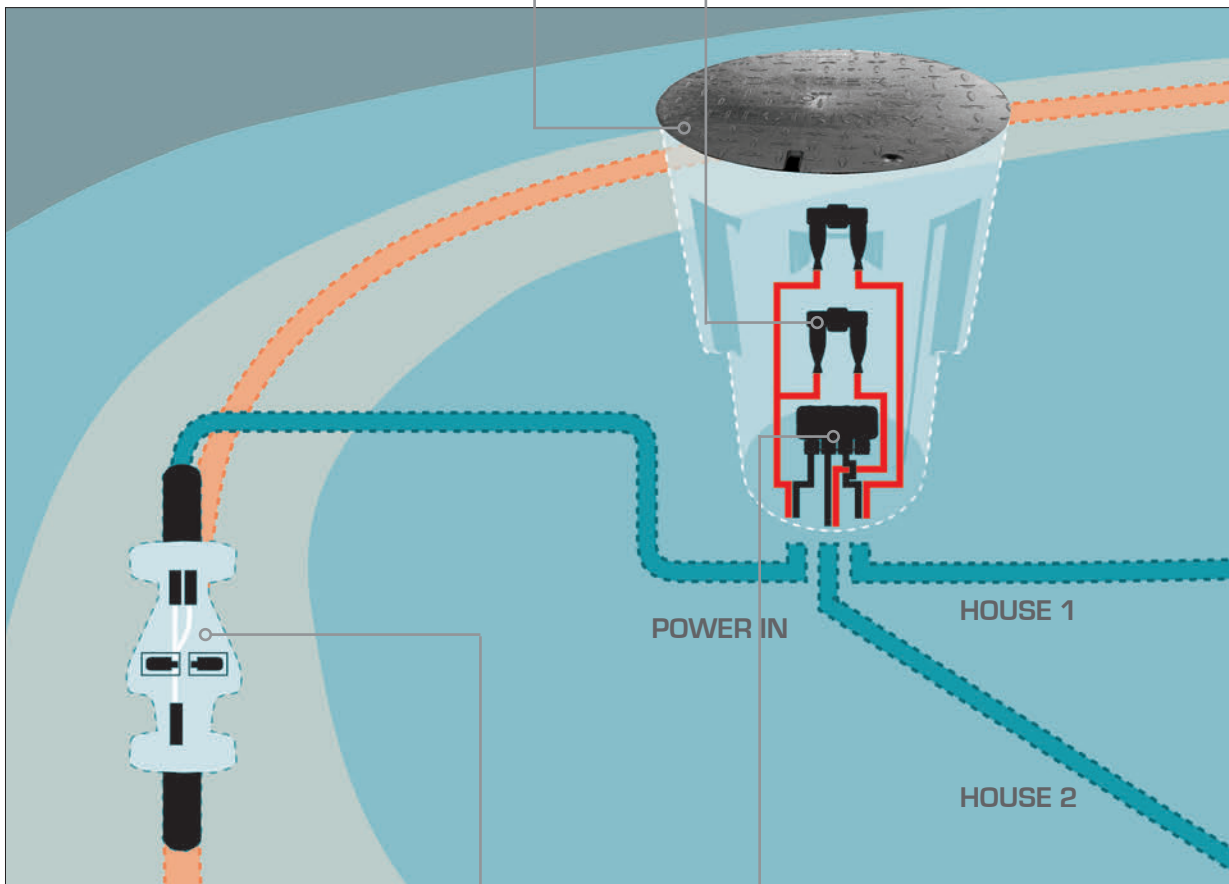

Guro MM5 Branch Joint Kit: Used to tap a supply from the main transformer cable to the pit. Can connect single & multicore main cable to single & multicore supply cable. Environmentally friendly insulating compound.

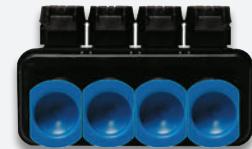

Gelport Connector: An insulated multiport connector used to create a busbar. Accepts both copper and aluminium cable. 6mm²-150mm² (larger 16-240mm² also available) ANSI C119.1,2002.

TUDS RESIDENTIAL INSTALLATION



TUDS offers unprecedented flexibility to the placement of distribution service demarcation points for utilities. Designed specifically for the New Zealand market, this system considers and accommodates the many challenges faced by asset owners when building and maintaining LV networks.

KEY FEATURES:

- No cutting of main cable – keeps resistance low and reduces amount of main cable required (no looping in & out)
- Completely submersed/ground mount – protected from impact and vandalism, space saving
- Up to 100amp fusing – perfect for residential and light commercial applications
- Multiple security levels available – latch and key lock
- Sturdy and UV stable – manufactured from the best materials and tested to ensure longevity



RESIDENTIAL & COMMERCIAL USE

RESIDENTIAL

TUDS means no more distribution pillars to detract from the beauty of your stunning new home. With the versatility of TUDS, you can install it in a driveway or lawn and forget it's even there. There is no longer a need to design the layout of your property around the position of your distribution pillars.

Also with TUDS there is now no excuse for placing hazards in the paths of children, the elderly and unwary. With the TUDS system available at such a reasonable cost, there's no need to pay more to keep your family safer.

The way our city's are developing, there is more and more demand for land and to get the most out of what is available. Infill



housing is a way of intensifying housing availability in cities and TUDS help make that happen without impacting crucial space for accessways.

COMMERCIAL & LIGHT INDUSTRIAL

TUDS means you can choose the location of your distribution pillar. Flush with the ground to greatly reduce visual impact TUDS can be installed in the driveway, footpath or lawn with ease.

Because of high impact lids and the flush mount design the TUDS system increases security of supply by reducing the chances of vandalism and accidental damage.

With fusing up to 100amps, TUDS can accommodate the

demand of commercial and light industrial business with ease, all while ensuring the connection to the network is tucked safely away from traffic and potential impact.

At Summerset retirement village TUDS pits have been placed in garden areas to lessen their visual impact even further. Because they are totally unaffected by water immersion it is perfectly safe to have a watering system adjacent to the pit. We think you will agree they are very unobtrusive.



CAMBRIDGE TOWN CENTRE



KEY FEATURES:

- Removes pedestrian trip hazard
- Improves public safety – no potentially live fittings are accessible by the public
- Declutters street and shop frontages
- Allows for reticulation to be safely out of the way in busy accessways – improves integrity of the network by outages caused by impacts
- Perfect for retrofit infill applications where space is at a premium

When the time comes to give your town centre an upgrade why not remove the clutter of service pillars and replace them with TUDS pits. The TUDS system gives you the flexibility to place your services in high foot traffic areas and service vehicle lanes without encroaching on the functionality of the area. The TUDS system can be incorporated into a variety of different footpath and service lane finishes. Cluttered store frontages can be a thing of the past, with TUDS you will achieve the clean and tidy look to your town centre, enhancing the street appeal you had hoped for.



As well as street appeal there's public safety; placing hazards in the path of the elderly and unwary makes no sense when the TUDS system is available at the same or similar cost, there's just no need to place pedestrians at risk of falling over ugly service pillars.

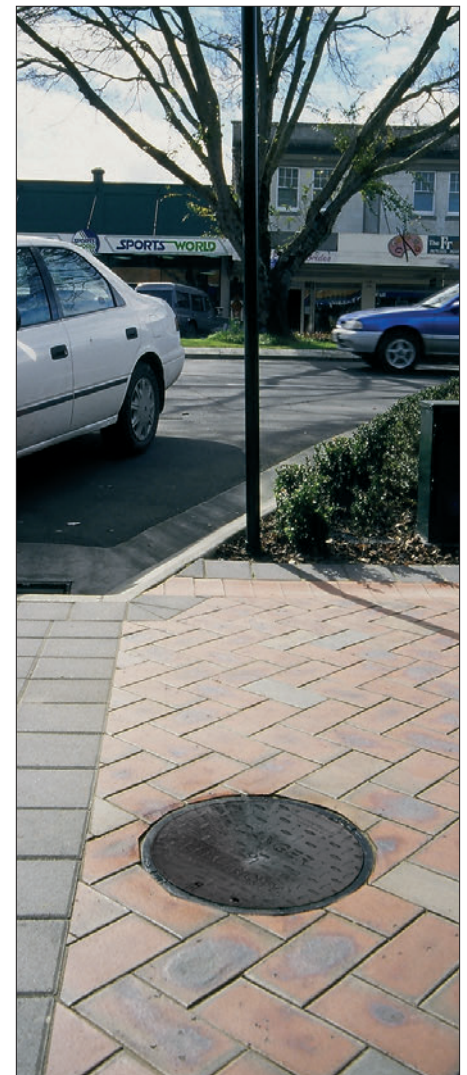

TUDS PARTS AND ACCESSORIES

TUDS PITS

This pit is strong and versatile, made from durable, black, UV stable plastic compounds. TUDS pits are easily capable of having a car drive over or park on them (when complete with TUDS325SLID pit lid).



TransNet Code	Contents	Style	Stainless Steel Lock	Dimensions (mm)
TUDS325S	PIT	STANDARD	NO	440x660x330
TUDS325SPITLOCKING			YES	
PITLIDKIT	PIT & LID	STANDARD	NO	440x660x330
TUDS325SLOCKING			YES	
TUDS325L		LARGE, BELL BOTTOM	NO	434x700x614
TUDS325LLOCKING			YES	

TUDS PIT LIDS

Made from durable, black, UV stable plastic compounds. Can be parked on and driven over. Locks into place and requires a tool for entry.

TUDS325SLIDLOCKING offers the same standard locking latches of the TUDS325SLID but it also has a stainless steel spring loaded lock which requires a key to unlock it.



TransNet Code	Description
TUDS325SLID	HEAVY DUTY SERVICE PIT LID, ONLY FOR TUDS325S
TUDS325SLIDLOCKING	HEAVY DUTY LOCKING PIT LID ONLY, FOR TUDS325SLOCKING

TUDS PIT300D KITSET OPTIONS

PIT300D kits come complete with fuse carrier, fuse links, pit, lid, Gelport for neutral, neutral tag and heatshrink break out boot.

These kits are perfect for situations where a branch off the main isn't required.

Available in 1ph, 2ph and 3ph, these kits can be paired with Guro resin kits should you require one and hot water or streetlight pilot connections can also be added.

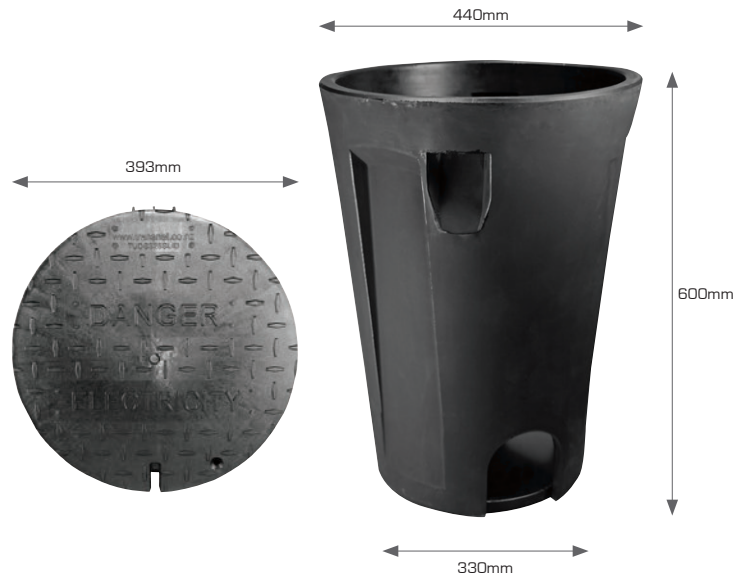

TransNet Code

Description

PIT300D1PH

SINGLE PHASE PIT ASSEMBLY

PIT300D2PH

TWO PHASE PIT ASSEMBLY

PIT300D3PH

THREE PHASE PIT ASSEMBLY

TUDS KITSET OPTIONS



TUDS kits have all the components included in the PIT300D kits but they also include a Guro resin branch joint for connection to main and some incidental connectors and heatshrink to terminate customer service cable which doesn't meet Australian Standard AS4026.

These kits are available in 1ph, 2ph and 3ph with mains cable from 50mm² up to 240mm² 4 core. They also have the added versatility of being able to accommodate hot water and streetlight fusing if required.

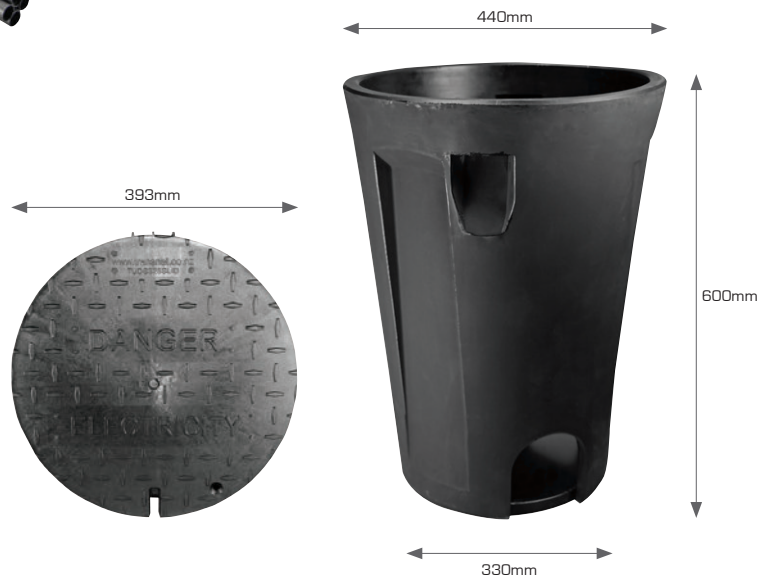

TransNet Code

Description

TransNet Code	Description
TUDS1PH70-150	SINGLE PHASE TUDS KIT, 70-150MM ² MAIN
TUDS1PH150-185	SINGLE PHASE TUDS KIT, 150-185MM ² MAIN
TUDS1PH240	SINGLE PHASE TUDS KIT, 240MM ² MIAN
TUDS2PH70-150	2 PHASE TUDS KIT, 70-150MM ² MAIN
TUDS2PH150-185	2 PHASE TUDS KIT, 150-185MM ² MAIN
TUDS2PH240	2 PHASE TUDS KIT, 240MM ² MIAN
TUDS3PH50-70	3 PHASE TUDS KIT, 50-70MM ²
TUDS3PH70-150	3 PHASE TUDS KIT, 70-150MM ² MAIN
TUDS3PH150-185	3 PHASE TUDS KIT, 150-185MM ² MAIN
TUDS3PH240	3 PHASE TUDS KIT, 240MM ² MIAN

TUDS KIT OPTIONS & ACCESSORIES

ADDITIONAL COMPONENTS

As well as the TUDS kit, often there are other modules you will require for an installation. Modules such as additional phase fuses, hot water/streetlight pilots, earthing and end of run applications.

To make life easier, we have kits for these applications available too. Simply choose what you need and add that module to your order.



TransNet Code	Description
TUDSEARTHLEADTRANS	EARTH LEAD TRANSITION KIT FOR TUDS
TUDSPILOTX1	SINGLE PILOT FUSE KIT FOR TUDS
TUDSPILOTSX2	TWO PILOT FUSE KIT FOR TUDS
TUDSPILOTSX3	THREE PILOT FUSE KIT FOR TUDS
TUDSPHASEEXTENSION	SINGLE FUSE PHASE EXTENSION KIT FOR TUDS

ACCESSORIES

There are also a range of tools and accessories available to complement the TUDS range. This group of products are designed to work with all TUDS applications.

The lid lifting tool will make access to the contents of the TUDS pit fast and simple, while the key will keep the TUDS pit secure to all those except approved staff.



TransNet Code	Description
0-0361414-3	TUDS PIT LID LIFTING TOOL
EPTS/SLOCKKEY	STAINLESS STEEL TRIANGULAR KEY FOR TUDS & ECOPILLAR
6-1198553-1	YELLOW REPLACEMENT SHEAR BOLT FOR K199 FUSE
FA2S000000000	NEUTRAL TAG, TESTED & APPROVED FOR LIVENING
PITLIDSCREW	STAINLESS STEEL ALLEN SCREW FOR TUDS LID
TUDSIDENTKIT1	TUDS LABELLING KIT - CRITCHLEY K65 MARKERS

EARTH ROD PROTECTION BOXES

TNERIB - EARTH ROD INSPECTION BOX



Designed by NZ contractors for NZ contractors! Improve the look and safety of your installation with this unit. This unit offers a strengthened lid for longevity.

FEATURES:

- Heavy duty hinged lid
- Lid latches closed
- UV stabilised material
- Easy to identify
- Designed and manufactured in NZ



TransNet Code

TNERIB

Description

EARTH ROD INSPECTION BOX - 120 x 120 x 200mm

ERICO EARTH ROD INSPECTION BOX

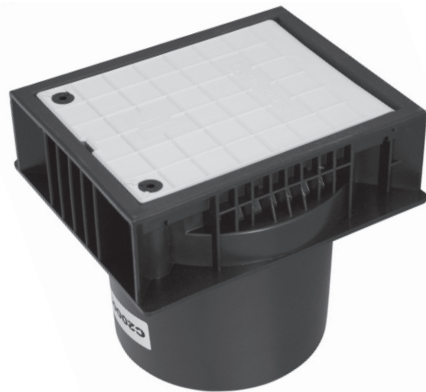

The ERITECH PITO3 offers a high level of protection for critical grounding terminations through the use of its lockable lid. Ease of maintenance of the ground termination is gained by way of the large working aperture once the lid is unlocked using the security key.

Due to its lightweight robust construction the ERITECH PITO3 can withstand 5 tonnes making it ideal for installation in heavy traffic areas.

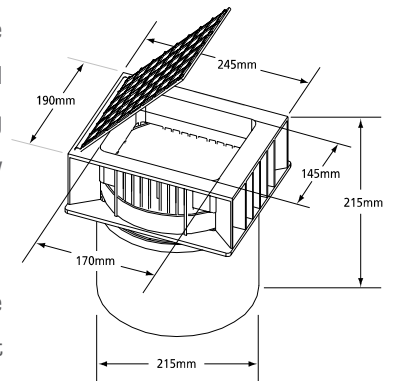

TransNet Code

C2000930

Description

EARTH ROD INSPECTION BOX - 215H x 215D x 190W x 245L mm

BURIED CABLE ENCLOSURE PIT



Being that it's so versatile, this Buried Cable Enclosure Pit is widely used in electrical, telephone and water industries. Made of high density polyethylene structural foam, this rigid enclosure is light weight and easy to handle.

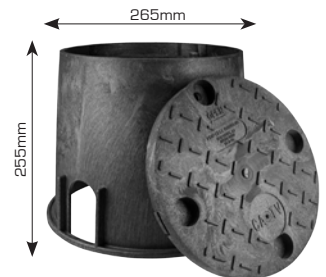

TransNet Code

PE9HDHK

Description

CIRCULAR PLASTIC VAULT - 265 x 255mm



Before



After

The driveway shown above was blighted by the presence of a large ugly pillar which was not only visually awful but a dangerous obstruction handily placed to be repeatedly run over by vehicles using the driveway. One can see from the picture and the angle of the pillar that this was obviously a regular occurrence. The use of TUDS pits has tidied the area up and provided a much safer environment.

TransNet New Zealand Ltd.

78 Cryers Road, East Tamaki, Auckland, New Zealand

PO Box 39 383, Howick, Auckland, New Zealand

www.transnet.co.nz

New Zealand

Phone: 0800 442 182

Fax: 0800 442 183

sales@transnet.co.nz



EDITION: 2.5
CATALOGUE # NEWERACAT 02/17

